



RCDD^{Q&As}

BICSI Registered Communications Distribution Designer – RCDDv14

Pass BICSI RCDD Exam with 100% Guarantee

Free Download Real Questions & Answers **PDF** and **VCE** file from:

<https://www.pass4itsure.com/rcdd.html>

100% Passing Guarantee
100% Money Back Assurance

Following Questions and Answers are all new published by BICSI
Official Exam Center

- ⚙️ **Instant Download** After Purchase
- ⚙️ **100% Money Back** Guarantee
- ⚙️ **365 Days** Free Update
- ⚙️ **800,000+** Satisfied Customers





QUESTION 1

During the program execution stage the component project manager responsible for testing estimates that budgeted hours may exceed 200 hours. What should the program manager do?

- A. Communicate to the program sponsor regarding the additional estimated cost and request a change order
- B. Determine which component protects have excess capacity and rebalance those resources to the project that needs additional hours
- C. Request that the project manager make the team members work additional hours and not bill the protect
- D. Talk with the project manager and find ways to reduce hours in another part of the project

Correct Answer: D

QUESTION 2

NRZ is the acronym for which of the following?

- A. Non-return to zero.
- B. Nominal return zone.
- C. Network registration zone.
- D. Normal return zone.

Correct Answer: A

QUESTION 3

The program manager plans to address a negative cost variance generating a red flag in the program management status report. What should the program manager do?

- A. Contact the project sponsors to present the details, impacts, and possible corrective actions regarding the negative cost variance
- B. Gather all the details, analyze impacts, determine corrective actions and present the findings to the governance board for direction
- C. Work with program sponsor to compile impact analysis data to obtain additional funding for the program
- D. Ask the program team to compile all details, analyze impacts, determine corrective actions and present to the governance board for direction

Correct Answer: B

QUESTION 4



Exhibit:

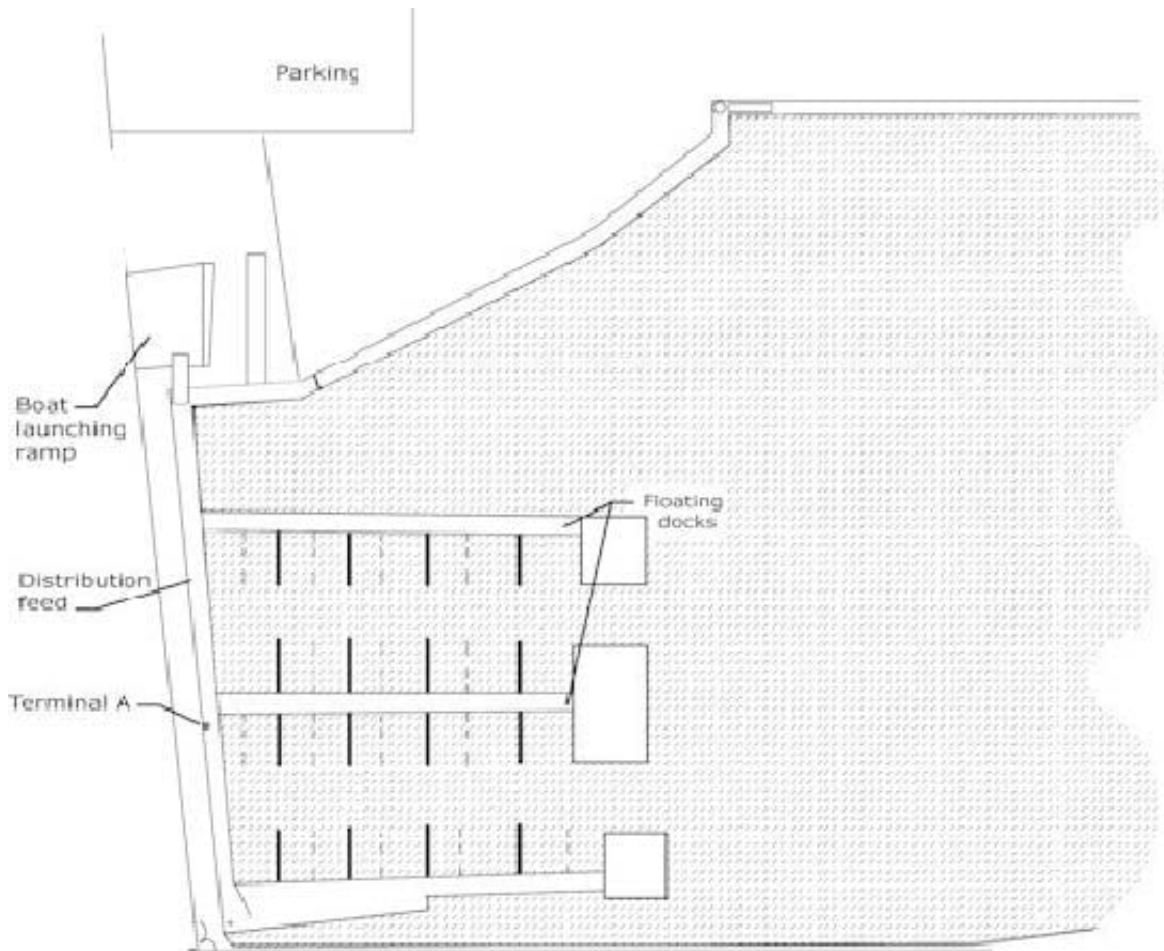

In this future marina layout, assuming that there are fewer than 10 slips being cabled, what would be the pre-cabling guideline to follow for terminal A?

- A. Installed one or two pair cables from the boat slips to a distribution terminal on the closest point of land.
- B. Place distribution cable onto the dock and terminate in a suitable cabinet or enclosure. Install service drop to each boat slip.
- C. Pre-cable each boat slip during construction.
- D. For security, each install should be terminated in the patch panel/cross-connect at the dockmaster or marina office.

Correct Answer: A

QUESTION 5

When designing an underground conduit system, a single bend should be NO MORE THAN _____ degrees.

A. 45

B. 75



C. 90

D. 120

Correct Answer: C

[Latest RCDD Dumps](#)

[RCDD VCE Dumps](#)

[RCDD Practice Test](#)